

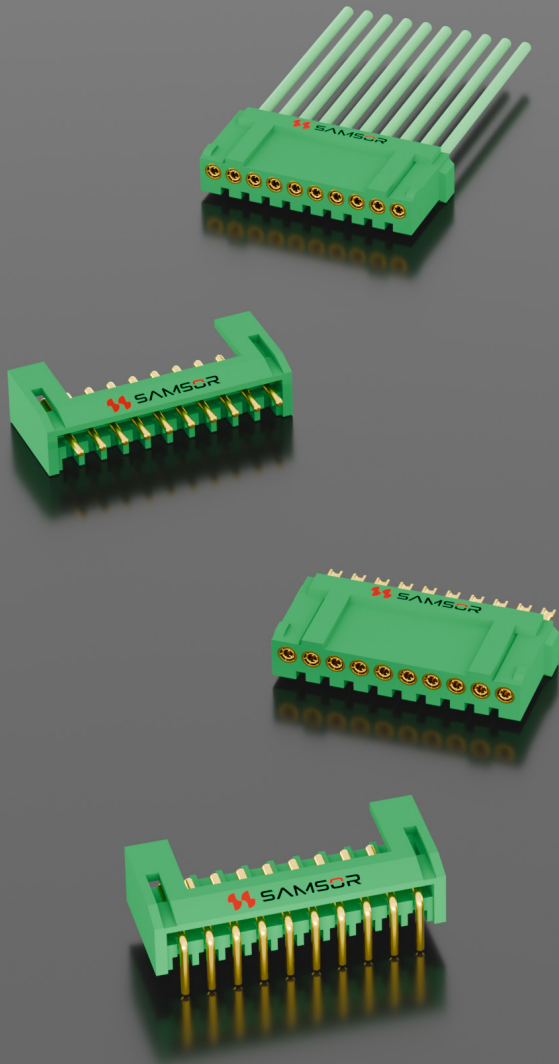



# JL4 Series

## PCB Connector

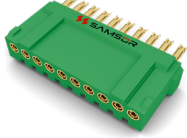
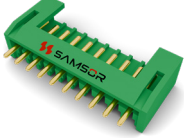

## Product Selection Guide

JL4 Standard Series		
 <p><b>2</b></p>	 <p><b>3</b></p>	 <p><b>4</b></p>
Pre-wired Plug	Pre-wired Plug(Double-Ended Cable)	Solder Cup Plug
 <p><b>5</b></p>	 <p><b>6</b></p>	
Vertical PCB Receptacle	Right Angle PCB Receptacle	

## Features

Corresponding to the National Military Standard GJB 1438A-2006
Number of Contacts: Available in 9 configurations with 2, 3, 4, 5, 6, 7, 8, 9 and 10 pins
Hyperboloid spring socket contact structure, with 2mm standard spacing, arranged in a single row
Conductor cross-sectional area suitable for 0.1mm <sup>2</sup> to 0.15mm <sup>2</sup> . For thinner wires, modification is required; please specify when ordering. Default supply: 0.15mm <sup>2</sup> green high-temperature silver-plated wrapped wire

## Performance Specifications

<b>Operating Temperature:</b> -65°C~ +125°C	<b>Dielectric Withstand Voltage:</b> 1000V (AC)
<b>Rated Voltage:</b> 300V AC	<b>Durability:</b> 500 times
<b>Rated Current:</b> 1A	<b>Vibration:</b> 10Hz~2000Hz acceleration 147m/s <sup>2</sup> Interruption duration ≤ 1μs
<b>Insulation Resistance:</b> ≥ 5000MΩ (at normal condition)	<b>Shock:</b> 980m/s <sup>2</sup> Interruption duration ≤ 1μs

## How to order

JL4	-	×	ZJ/TK	×	-	S	(Note)
<p><b>Series:</b> JL4</p> <p><b>Contact Layout:</b> 2、3、4、5、6、7、8、9、10</p> <p><b>Contact Type:</b> ZJ - Receptacle with Pin      TK - Plug with Socket</p> <p><b>Termination Type:</b>                      B - Vertical PCB      W - Right angle PCB                      Y - Pre-wired      H - Solder Cup</p> <p><b>Cable Type:</b> S - Double-ended Cable      Omit - Single-ended Cable</p>							

### Note: Wire Requirements for Pre-wired Product

If not specified, the default configuration is L=200 mm, AFR250 - 0.15mm<sup>2</sup>-250V, Green

If there are other requirements, specify as follows: Wire length (from the rear exit point, unit: mm, default: 200mm); Braid shield (P - Lightweight braided shield; default: no braid shield); Nylon sleeve (F - for military green nylon sleeve; Default: No nylon sleeve); Wire Grade (commonly AFR250, default AFR250); Wire Gauge (compatible with 0.1mm<sup>2</sup> - 0.15mm<sup>2</sup>, default: 0.15mm<sup>2</sup>); Wire Color (optional multiple colors, default: green), Default items may be omitted; all other requirements can be noted. The above notes do not appear on product markings. They only serve as wire requirements for ordering pre-wired products with leads. For additional wiring definitions or requirements, please contact our engineers.

### Note Examples:

(L600PF AFR250 0.15) - Length: 600mm, green wire, type AFR250, Gauge: 0.15mm<sup>2</sup>, braided shielding over wire; nylon sleeve over shielding

(L300F 0.1) - Length: 300mm, green wire, type AFR250, Gauge: 0.1mm<sup>2</sup>, without braid shield, with nylon sleeve over the wire

**Pre-wired Plug**

JL4	-	10	TK	Y	-	L	(Note)
-----	---	----	----	---	---	---	--------

Series: JL4

Contact Layout: 2, 3, 4, 5, 6, 7, 8, 9, 10

Contact Type: TK - Plug with Socket

Termination Type: Y - Pre-wired

Wire Length: Default wire length is L = 200 mm

Note: For wire configuration, please refer to the notes in the "Model Naming" section

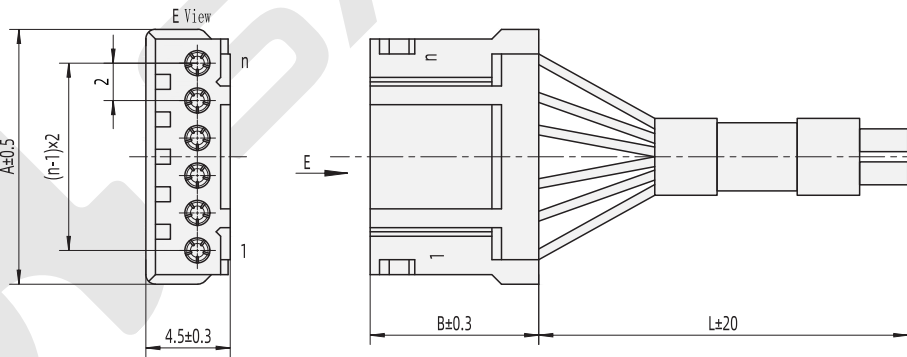
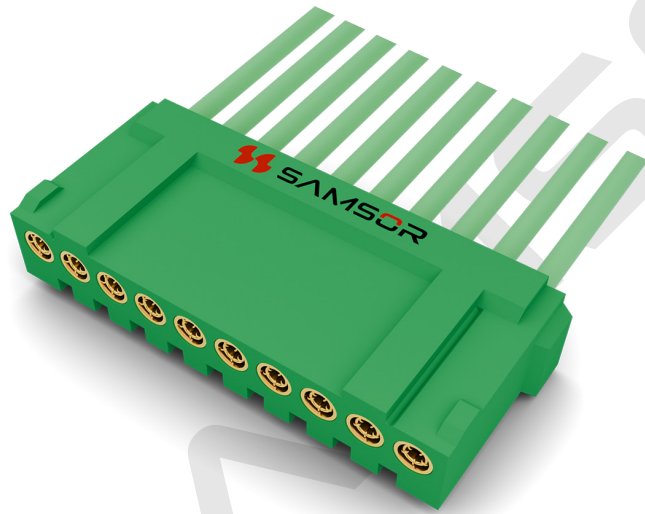

Type	JL4-2TKY-L	JL4-3TKY-L	JL4-4TKY-L	JL4-5TKY-L	JL4-6TKY-L
A	5.6	7.6	9.6	11.6	13.6
B	9	9	9	9	9
n (Layout)	2	3	4	5	6
Type	JL4-7TKY-L	JL4-8TKY-L	JL4-9TKY-L	JL4-10TKY-L	
A	15.6	17.6	19.6	21.6	
B	9	9	9	10	
n (Layout)	7	8	9	10	

**JL4 Series**

## Pre-wired Plug

JL4	-	10	TK	Y	-S	-	L	(Note)
-----	---	----	----	---	----	---	---	--------

**Series:** JL4

**Contact Layout:** 2、3、4、5、6、7、8、9、10

**Contact Type:** TK - Plug with Socket

**Termination Type:** Y - Pre-wired

**Cable Type:** S - Double-ended Cable

**Wire Length:** Default wire length is L = 200 mm

**Note:** For wire configuration, please refer to the notes in the "Model Naming" section

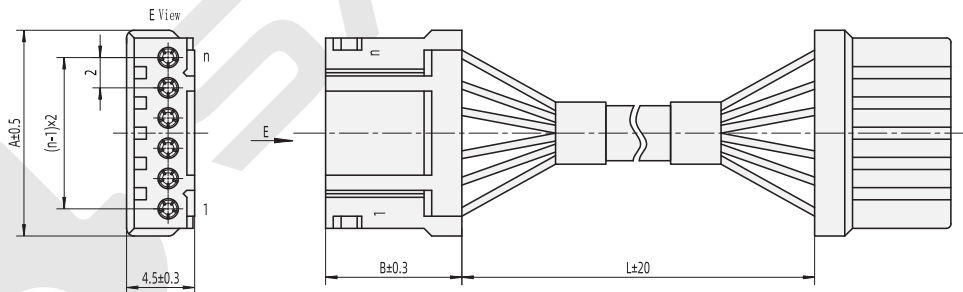
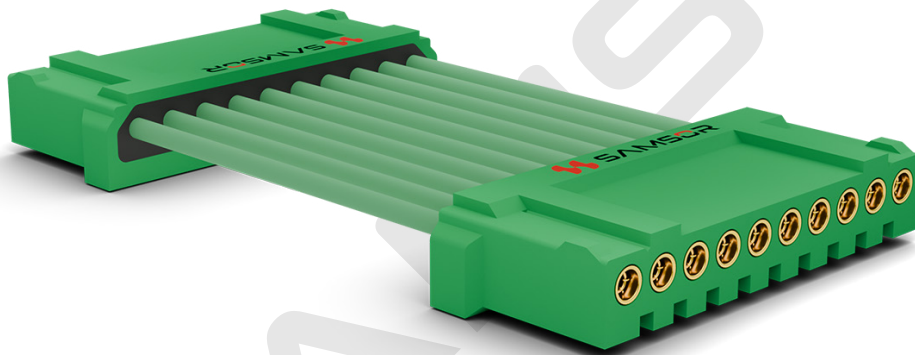

Type	JL4-2TKY-SL	JL4-3TKY-SL	JL4-4TKY-SL	JL4-5TKY-SL	JL4-6TKY-SL
A	5.6	7.6	9.6	11.6	13.6
B	9	9	9	9	9
n (Layout)	2	3	4	5	6
Type	JL4-7TKY-SL	JL4-8TKY-SL	JL4-9TKY-SL	JL4-10TKY-SL	
A	15.6	17.6	19.6	21.6	
B	9	9	9	10	
n (Layout)	7	8	9	10	

**Solder Cup Plug**

JL4	-	10	TK	H
-----	---	----	----	---

Series: JL4

Contact Layout: 2, 3, 4, 5, 6, 7, 8, 9, 10

Contact Type: TK - Plug with Socket

Termination Type: H - Solder Cup

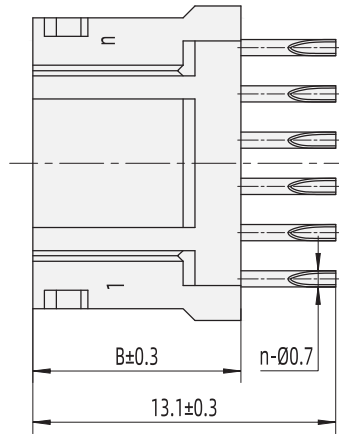
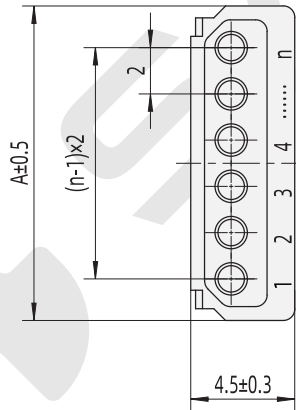
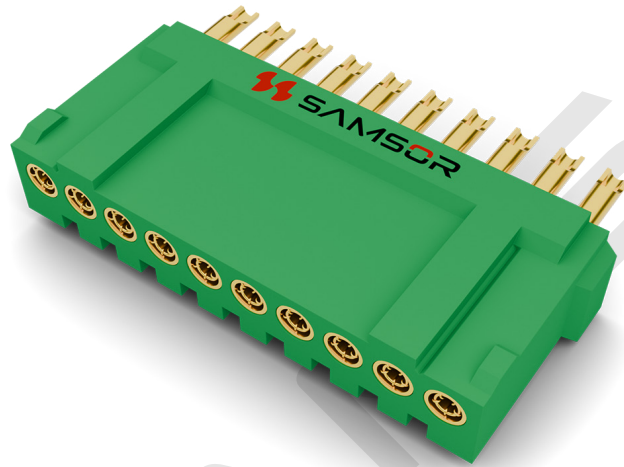

Type	JL4-2TKH	JL4-3TKH	JL4-4TKH	JL4-5TKH	JL4-6TKH
A	5.6	7.6	9.6	11.6	13.6
B	9	9	9	9	9
n (Layout)	2	3	4	5	6
Type	JL4-7TKH	JL4-8TKH	JL4-9TKH	JL4-10TKH	
A	15.6	17.6	19.6	21.6	
B	9	9	9	10	
n (Layout)	7	8	9	10	

**JL4 Series**

## PCB Receptacle-Vertical

JL4	-	10	ZJ	B	-	XX
-----	---	----	----	---	---	----

**Series:** JL4

**Contact Layout:** 2、3、4、5、6、7、8、9、10

**Contact Type:** ZJ - Receptacle with Pin

**Termination Type:** B - Vertical PCB

**Pin Length:** No marking: Default length is 3.0mm      -1: Default length is 4.5mm      -2: Default length is 5.0mm

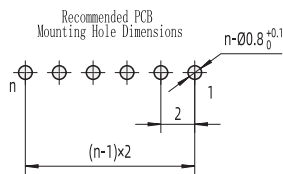
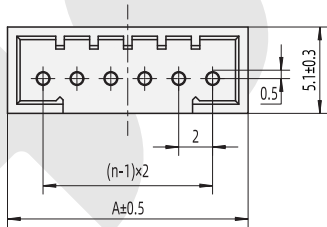
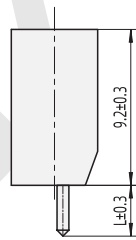
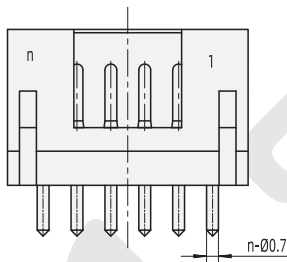
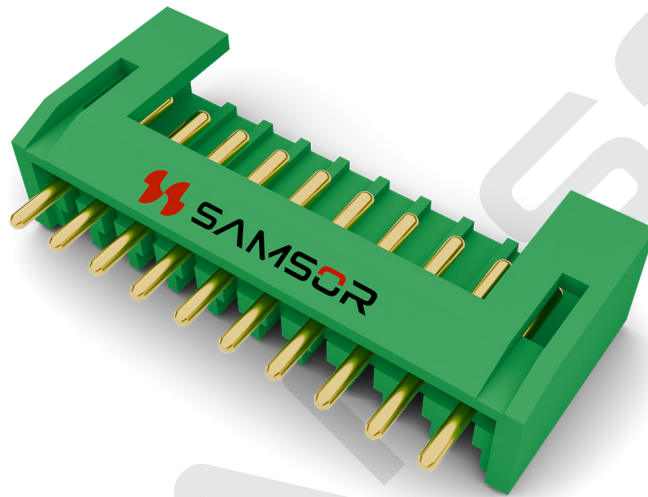

- JL4-ZJB: Standard type, L=3.0mm
- JL4-ZJB-1: Extended pin type, L=4.5mm
- JL4-ZJB-2: Extended pin type, L=5.0mm

Type	JL4-2ZJB	JL4-3ZJB	JL4-4ZJB	JL4-5ZJB	JL4-6ZJB
A	6.2	8.2	10.2	12.2	14.2
n (Layout)	2	3	4	5	6
Type	JL4-7ZJB	JL4-8ZJB	JL4-9ZJB	JL4-10ZJB	
A	16.2	18.2	20.2	22.2	
n (Layout)	7	8	9	10	

**PCB Receptacle-Right Angle**

JL4	-	10	ZJ	W	-	XX
-----	---	----	----	---	---	----

Series: JL4

Contact Layout: 2, 3, 4, 5, 6, 7, 8, 9, 10

Contact Type: ZJ - Receptacle with Pin

Termination Type: W - Right angle PCB

Pin Length: No marking: Default length is 3.3mm      -1: Default length is 4.2mm      -2: Default length is 5.5mm

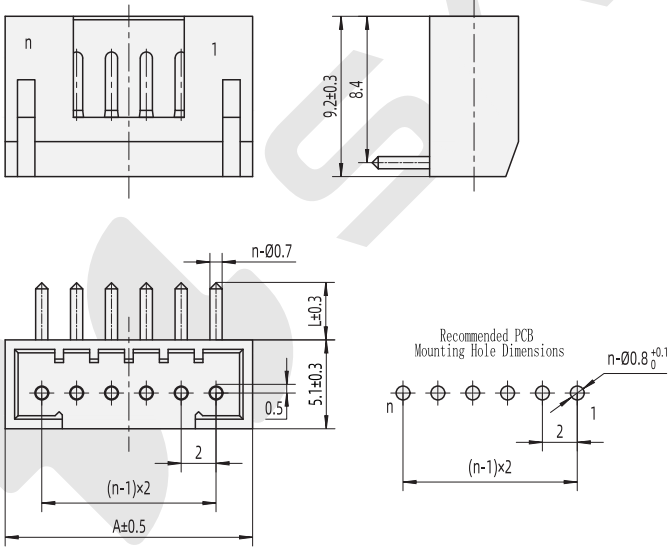
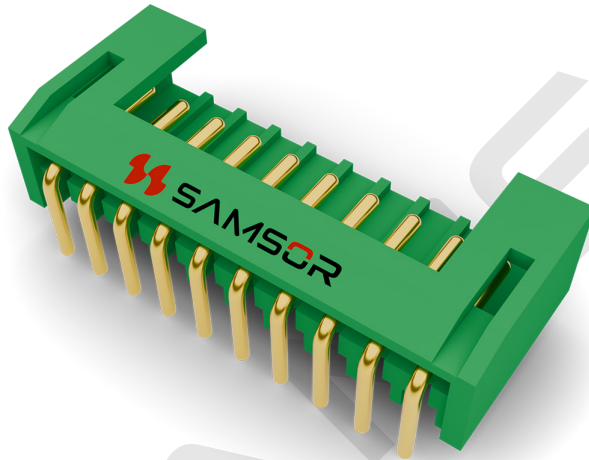

- JL4-ZJW: Standard type, L=3.3mm
- JL4-ZJW-1: Extended pin type, L=4.2mm
- JL4-ZJW-2: Extended pin type, L=5.5mm

Type	JL4-2ZJW	JL4-3ZJW	JL4-4ZJW	JL4-5ZJW	JL4-6ZJW
A	6.2	8.2	10.2	12.2	14.2
n (Layout)	2	3	4	5	6
Type	JL4-7ZJW	JL4-8ZJW	JL4-9ZJW	JL4-10ZJW	
A	16.2	18.2	20.2	22.2	
n (Layout)	7	8	9	10	

**JL4 Series**

## Note

- The through-hole diameter for the solder pin mounting shall be greater than 0.8 mm (or 31 mil as specified), otherwise the solder pin may not pass through the PCB
- The solder pin length (L) shall be selected according to the PCB thickness (H). To ensure soldering quality, it is recommended that  $L - H \geq 1$  mm
- During soldering, the insulator must be flush with the PCB surface. Tilting or suspending the insulator is strictly prohibited
- For manual soldering, a solder temperature of  $(260 \pm 10)^\circ\text{C}$  is recommended, with soldering time not exceeding 5 seconds. When using a constant-temperature soldering iron at  $(350 \pm 10)^\circ\text{C}$ , the soldering time should be (2~3) seconds